

Reduction, butt welding, L=550mm

1. Product application

Belmaflex reductions, butt welding are dedicated to be used as a part of the preinsulated pipeline system for example as a jacket of the prefabricated preinsulated reducers as well as a jacket of preinsulated ball valves

2. Product parameters

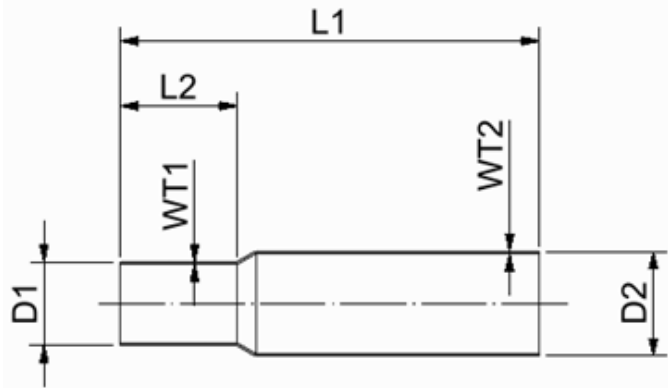

D1	D2	Item number	WT1-WT2 mm*	L1 [mm]	L2 [mm]
090	110	4509011005510	4,0	550 ±10	265±5
090	125	4509012505510	4,0	550 ±10	258±5
090	140	4509014005510	4,0	550 ±10	250±5
110	125	4511012505510	4,0	550 ±10	268±5
110	140	4511014005510	4,0	550 ±10	260±5
110	160	4511016005510	4,1	550 ±10	250±5
110	180	4511018005510	4,5	550 ±10	240±5
125	140	4512514005510	4,1	550 ±10	268±5
125	160	4512516005510	4,1	550 ±10	258±5
125	180	4512518005510	4,5	550 ±10	248±5
140	160	4514016005510	4,5	550 ±10	265±5
140	180	4514018005510	4,5	550 ±10	255±5
140	200	4514020005510	5,0	550 ±10	245±5
160	180	4516018005510	5,0	550 ±10	265±5
160	200	4516020005510	5,0	550 ±10	255±5
160	225	4516022505510	5,0	550 ±10	243±5
180	200	4518020005510	5,0	550 ±10	265±5
180	225	4518022505510	5,0	550 ±10	253±5
200	225	4520022505510	5,0	550 ±10	263±5
200	250	4520025005510	5,0	550 ±10	250±5
200	280	4520028005510	5,5	550 ±10	235±5
200	315	4520031505510	6,1	550 ±10	218±5
225	250	4522525005510	5,5	550 ±10	263±5
225	280	4522528005510	5,5	550 ±10	248±5
225	315	4522531505510	6,1	550 ±10	118±5
250	280	4525028005510	6,1	550 ±10	260±5
250	315	4525031505510	6,1	550 ±10	243±5
250	355	4525035505510	6,9	550 ±10	223±5
280	315	4528031505510	6,9	550 ±10	258±5
280	355	4528035505510	6,9	550 ±10	238±5
280	400	4528040005510	7,7	550 ±10	215±5

Reduction, butt welding, L=550mm

315	355	4531535505510	7,7	550 ±10	255±5
315	400	4531540005510	7,7	550 ±10	233±5
355	400	4535540005510	7,7	550 ±10	253±5
400	500	4540045005510	8,0	550 ±10	225±5
450	500	4545050005510	9,0	550 ±10	250±5
500	560	4550056005510	10,0	550 ±10	245±5
560	630	4556063005510	11,0	550 ±10	240±5
630	710	4563071005510	12,0	550 ±10	235±5
710	800	4571080005510	11,1	550 ±10	230±5
800	900	4580090005510	12,5	550 ±10	225±5
900	1000	4590010005510	12,9	550 ±10	225±5
1000	1100	4510011005510	13,3	550 ±10	225±5
1100	1200	4511012005510	13,8	550 ±10	225±5

*concerns raw material wall thickness before expansion / downsizing

- ❖ Belmaflex welding reductions are also supplied in standard lengths 400mm and can be supplied in any other lengths and combination of dimensions on customer request
- ❖ In case of a need for a specific product please contact our sales department

3. Material

High density polyethylene (material classification PE100)

4. Marking

White identification label placed in the middle of the product with information about the product parameters and production date.

5. Storage

In case of a long term storage, weldable PE products should be protected against direct exposition to sunlight as well as changeable temperature and weather conditions. The products should be protected against mechanical damages.