

Casing joint, shrinkable, L=700mm, packed in foil, Standard

1. Product application

Belmaflex casing joints, shrinkable are designed to create a perfect and strong joint in the connection areas of the two preinsulated pipes.

2. Product parameters

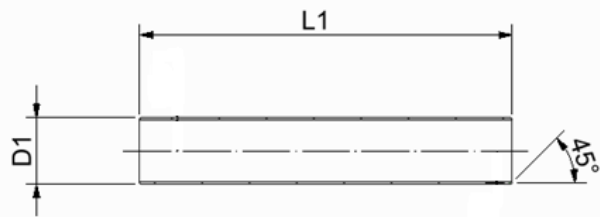
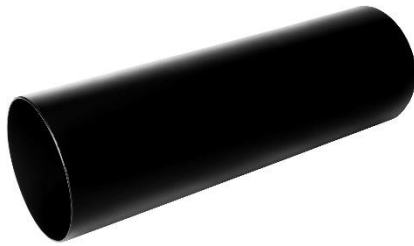

casing pipe outside diam [mm]	item no	L1 [mm]	min inside diameter before shrinking [mm]	WT* [mm]
75	110753007010	700 ±10	89	3
90	110903007011	700 ±10	105	3
110	111103007011	700 ±10	122	3
125	111253007011	700 ±10	140	3
140	111403007011	700 ±10	155	3
160	111603007011	700 ±10	176	3
180	111803007011	700 ±10	197	3
200	112003207011	700 ±10	217	3,2
225	112253407011	700 ±10	243	3,4
250	112503607011	700 ±10	269	3,6
280	112803907011	700 ±10	299	3,9
315	113153907011	700 ±10	336	3,9
355	113554507011	700 ±10	378	4,5
400	114006307011	700 ±10	420	5,3
450	114505207011	700 ±10	470	5,2
500	115005807011	700 ±10	520	5,8
560	115606007011	700 ±10	581	6,0
630	116307007011	700 ±10	659	7,0
710	117109807011	700 ±10	738	9,8
800	118001107011	700 ±10	836	11
900	119001297011	700 ±10	936	12,5
1000	111001297011	700 ±10	1042	12,9
1100	111101337011	700 ±10	1142	13,3
1200	111201387011	700 ±10	1242	13,8

*WT concern raw PE pipe material thicknesses before expansion / downsizing

Casing joint, shrinkable, L=700mm, packed in foil, Standard

- ❖ Belmaflex Casing Joints are also supplied in standard lengths 500, 600, 1000, 1200, 1400mm or can be supplied in any other lengths on customer request
- ❖ Belmaflex Casing Joints can be also supplied in **EXTRA WALL THICKNESS** version dedicated for electrical or extrusion welding
- ❖ In case of a need for a specific product please contact our sales department

3. Material

High density polyethylene (material classification PE100)

4. Marking

White identification label placed in the middle of the joint with information about the product parameters and production date.

5. Packing

According to the agreement with the customer products can be additionally supplied with below accessories:

- mastic (integrated or loose)
- shrink collars
- welding and venting plugs

6. Transport

General transport conditions apply as follow:

- Transport on a pallets
- The pallet should be wrapped with protective plastic foil in order to protect against dust, dirt and damage
- Protect the cargo against sunlight,
- Protect the cargo against rainfall/snowfall
- Pallets should be protected against falling and movement during transportation

7. Storage

General storage conditions apply as follow:

- store indoors or under cover,
- store in vertical position on a flat surface,
- protect against the possibility of damaging of products protective plastic foil
- protect from sunlight
- protect against rainfall/snowfall.
- in order to not activate the shrinking process (from 50°C) store in maximal temperatures not higher than 40 ° C

Belmaflex is not responsible for product damages caused by inappropriate storage.