

Casing joint, shrinkable, L=700mm, BFC1 - double sealed

1. Product application

Belmaflex BFC1 casing joint sets consist of standard shrinkable casing joints with integrated mastic and heat shrinkable collars (TPSM) as an additional sealing. Both products are perfectly matched to the preinsulated pipes casing dimensions which guarantees their fast and easy installation as well as the long life of the joint connection.

2. Product parameters

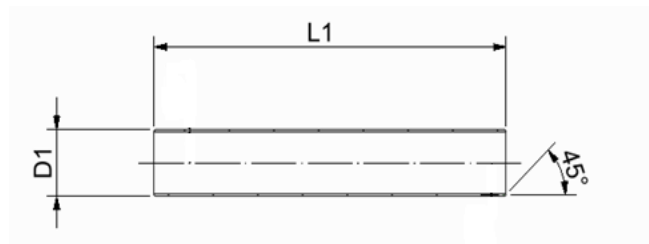

casing pipe outside diam [mm]	item no	L1 [mm]	min inside diameter before shrinking [mm]	WT* [mm]	shrink collar width [mm]
75	150753007012	700 ±10	89	3	150
90	150903007012	700 ±10	105	3	150
110	151103007012	700 ±10	122	3	150
125	151253007012	700 ±10	140	3	150
140	151403007012	700 ±10	155	3	150
160	151603007012	700 ±10	176	3	150
180	151803007012	700 ±10	197	3	150
200	152003207012	700 ±10	217	3,2	150
225	152253407012	700 ±10	243	3,4	150
250	152503607012	700 ±10	269	3,6	150
280	152803907012	700 ±10	299	3,9	150
315	153154507012	700 ±10	336	3,9	225
355	153554507012	700 ±10	378	4,5	225
400	154005307012	700 ±10	420	5,3	225
450	154505207012	700 ±10	470	5,2	225
500	155005807012	700 ±10	520	5,8	225
560	155606007012	700 ±10	581	6,0	225
630	156307007412	700 ±10	659	7,0	225
710	157109807012	700 ±10	738	9,8	225

*WT concern raw PE pipe material thicknesses before expansion / downsizing

❖ Belmaflex BFC1 Casing Joint sets can be also supplied in standard lengths 500, 600, 1000, 1200, 1400mm or can be supplied in any other lengths on customer request

Casing joint, shrinkable, L=700mm, BFC1 - double sealed

- ❖ Belmaflex Casing Joints can be also supplied in **EXTRA WALL THICKNESS** version dedicated for electrical or extrusion welding
- ❖ In case of a need for a specific product please contact our sales department

3. Material

High density polyethylene (material classification PE100)

4. Marking

White identification label placed in the middle of the joint with information about the product parameters and production date.

5. Packing

According to the agreement with the customer products can be additionally supplied with welding and venting plugs

6. Transport

General transport conditions apply as follow:

- Transport on a pallets
- The pallet should be wrapped with protective plastic foil in order to protect against dust, dirt and damage
- Protect the cargo against sunlight,
- Protect the cargo against rainfall/snowfall
- Pallets should be protected against falling and movement during transportation

7. Storage

General storage conditions apply as follow:

- store indoors or under cover,
- store in vertical position on a flat surface,
- protect against the possibility of damaging of products protective plastic foil
- protect from sunlight
- protect against rainfall/snowfall.
- in order to not activate the shrinking process (from 50°C) store in maximal temperatures not higher than 40 ° C

Belmaflex is not responsible for product damages caused by inappropriate storage.