

Casing joint, shrinkable, L=1200mm, packed in foil, Standard

1. Product application

Belmaflex casing joints, shrinkable are designed to create a perfect and strong joint in the connection areas of the two preinsulated pipes.

2. Product parameters

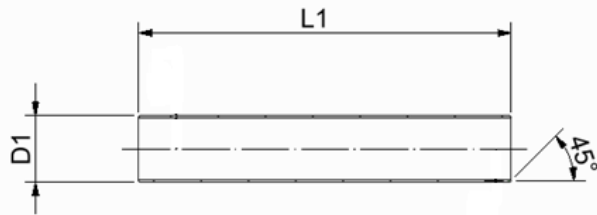
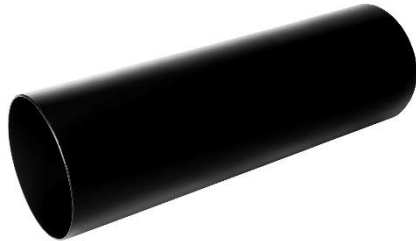

casing pipe outside diam [mm]	item no	L1 [mm]	min inside diameter before shrinking [mm]	WT* [mm]
75	1907530012010	1200 ±10	89	3,0
90	1909030012010	1200 ±10	105	3,0
110	1911030012010	1200 ±10	125	3,0
125	1912530012010	1200 ±10	140	3,0
140	1914030012010	1200 ±10	155	3,0
160	1916030012010	1200 ±10	176	3,0
180	1918030012010	1200 ±10	197	3,0
200	1920032012010	1200 ±10	217	3,2
225	1922534012010	1200 ±10	243	3,4
250	1925036012010	1200 ±10	269	3,6
280	1928039012010	1200 ±10	299	3,9
315	1931539012010	1200 ±10	336	3,9
355	1935545012010	1200 ±10	378	4,5
400	1940053012010	1200 ±10	420	5,3
450	1945052012010	1200 ±10	470	5,2
500	1950070012010	1200 ±10	520	7,0
500	1950078012010	1200 ±10	520	7,8
560	1956078012010	1200 ±10	581	7,8
560	1956088012010	1200 ±10	581	8,8
630	1963088012010	1200 ±10	659	8,8
630	1963009812010	1200 ±10	659	9,8
710	1971098012010	1200 ±10	738	9,8
710	1971011112010	1200 ±10	738	11,0
800	1980011112010	1200 ±10	836	11,0
800	1980012512010	1200 ±10	836	12,5
900	1990012512010	1200 ±10	936	12,5
900	1990012912011	1200 ±10	936	12,9

Casing joint, shrinkable, L=1200mm, packed in foil, Standard

1000	1910012912010	1200 ±10	1042	12,9
1000	1910013312010	1200 ±10	1042	13,3

*WT concern raw PE pipe material thicknesses before expansion / downsizing

- ❖ **Belmaflex Casing Joints are also supplied in standard lengths 500, 600, 700, 1000, 1400mm or can be supplied in any other lengths on customer request**
- ❖ **Belmaflex Casing Joints can be also supplied in **EXTRA WALL THICKNESS** version dedicated for electrical or extrusion welding**
- ❖ **In case of a need for a specific product please contact our sales department**

3. Material

High density polyethylene (material classification PE100)

4. Marking

White identification label placed in the middle of the joint with information about the product parameters and production date.

5. Packing

According to the agreement with the customer products can be additionally supplied with below accessories:

- mastic (integrated or loose)
- shrink collars (TPSM)
- welding and venting plugs

6. Transport

General transport conditions apply as follow:

- Transport on a pallets
- The pallet should be wrapped with protective plastic foil in order to protect against dust, dirt and damage
- Protect the cargo against sunlight,
- Protect the cargo against rainfall/snowfall
- Pallets should be protected against falling and movement during transportation

7. Storage

General storage conditions apply as follow:

- store indoors or under cover,
- store in vertical position on a flat surface,
- protect against the possibility of damaging of products protective plastic foil
- protect from sunlight
- protect against rainfall/snowfall.
- in order to not activate the shrinking process (from 50°C) store in maximal temperatures not higher than 40 ° C

Belmaflex is not responsible for product damages caused by inappropriate storage.